

SECTION A
 HORIZONTAL 1:100
 VERTICAL 1:100

MODIFY LOCATION OF EXISTING GULLY PIT

NOTES

- FOR TYPICAL KERB AND DRIVEWAY CROSS SECTIONS REFER DRG 2116280AC05.
 FOR DRAINAGE DETAILS REFER DRG 2116280AC05
 - SAW CUTS: PRIOR TO ANY SAW CUTS OCCURRING ON SITE THE SUB CONTRACTOR SHALL:
 - SUBMIT DETAILS OF THE PROPOSED CUTTING METHODOLOGY TO THE COUNCIL FOR APPROVAL AND DEMONSTRATE SUFFICIENT SKILLED SAWING EQUIPMENT OPERATORS;
 - MARK OUT ON SITE ALL SAW CUTS FOR APPROVAL BY THE COUNCIL PRIOR TO COMMENCING CUTTING;
 - SAW CUTS SHALL BE SIZED AS PER HISTORIC PAVING (450MM GRID). ALL CUTS SHALL BE CLEAN STRAIGHT LINES, WITH A CONSTANT WIDTH, SPACING AND DEPTH. AVOID OVER CUTS, AND INSTALL TEMPORARY PROTECTIVE SHEETING AS REQUIRED TO PROTECT ADJACENT VERTICAL SURFACES; &
 - SAW CUTS MUST BE CARRIED OUT WITHIN 24 HOURS OF POURING.
- * EXISTING PAVEMENT TO BE RETAINED

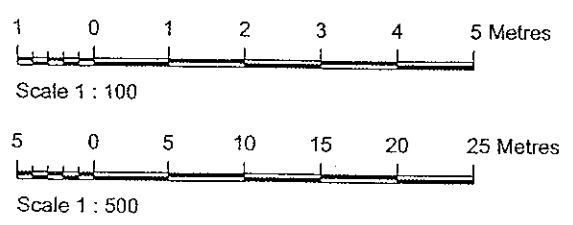

FOR CONSTRUCTION

REV	DATE	DESCRIPTION	DRN.	APPR.
C	03.11.05	BLUESTONE BANDING ADDED	RIR	ML
B	27.05.05	FOOTPATH WIDENING REVISED. GULLY PIT ADDED	CD	ML
A	18.03.05	ISSUED FOR CONSTRUCTION	KD	ML

© Parsons Brinckerhoff Australia Pty Limited and Parsons Brinckerhoff International (Australia) Pty limited trading as Parsons Brinckerhoff ("PB") Copyright in the drawings, information and data recorded in this document ("the information") is the property of PB. This document and the information are solely for the use of the authorised recipient and this document may not be used, copied or reproduced in whole or part for any purpose other than that for which it was supplied by PB. PB makes no representation, undertakes no duty and accepts no responsibility to any third party who may use or rely upon this document or the information.
 NCSI certified Quality System to ISO 9001

Scale	A3 ORIGINAL	Drawn	CFD	Date
		Designed	MD	Date
		Drawing Check	CD	Date 80305
		Design Check	MD	Date 80305
		Project Approval		Date

PARSONS BRINCKERHOFF
 PPK House, Level 3
 9 Blaxland Road
 Rhodes NSW 2138
 Locked Bag 248,
 Rhodes NSW 2138
 Australia

ABN 84 797 323 433
 Telephone +61 2 9743 0333
 Facsimile +61 2 9736 1568
 Email: sydney@pb.com.au

Client	ROADS AND TRAFFIC AUTHORITY OF N.S.W.	Job No	2116280A
Project	PADDINGTON LOCAL AREA TRAFFIC MANAGEMENT NEILD AVENUE BETWEEN DILLON STREET AND LAWSON STREET GENERAL ARRANGEMENT	File No	2116280AC02_C
		Drawing No	C02
		Rev	C

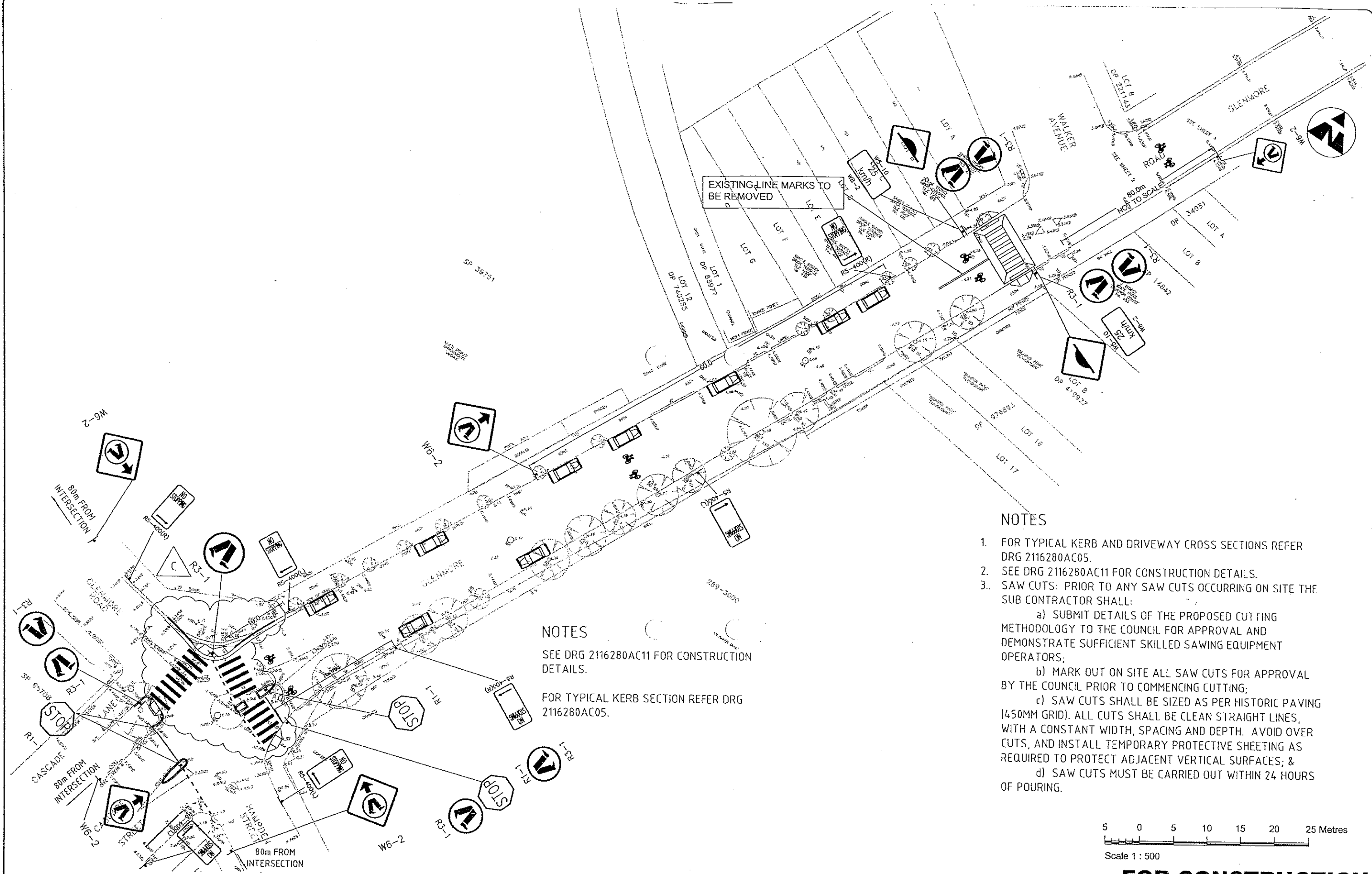

NOTES
 SEE DRG 2116280AC11 FOR CONSTRUCTION DETAILS.
 FOR TYPICAL KERB SECTION REFER DRG 2116280AC05.

NOTES

1. FOR TYPICAL KERB AND DRIVEWAY CROSS SECTIONS REFER DRG 2116280AC05.
2. SEE DRG 2116280AC11 FOR CONSTRUCTION DETAILS.
3. SAW CUTS: PRIOR TO ANY SAW CUTS OCCURRING ON SITE THE SUB CONTRACTOR SHALL:
 - a) SUBMIT DETAILS OF THE PROPOSED CUTTING METHODOLOGY TO THE COUNCIL FOR APPROVAL AND DEMONSTRATE SUFFICIENT SKILLED SAWING EQUIPMENT OPERATORS;
 - b) MARK OUT ON SITE ALL SAW CUTS FOR APPROVAL BY THE COUNCIL PRIOR TO COMMENCING CUTTING;
 - c) SAW CUTS SHALL BE SIZED AS PER HISTORIC PAVING (450MM GRID). ALL CUTS SHALL BE CLEAN STRAIGHT LINES, WITH A CONSTANT WIDTH, SPACING AND DEPTH. AVOID OVER CUTS, AND INSTALL TEMPORARY PROTECTIVE SHEETING AS REQUIRED TO PROTECT ADJACENT VERTICAL SURFACES; &
 - d) SAW CUTS MUST BE CARRIED OUT WITHIN 24 HOURS OF POURING.

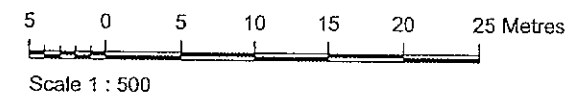

FOR CONSTRUCTION

REV	DATE	DESCRIPTION	DRN.	APPR.
C	03.11.05	KERB LINE AMENDED	RIR	ML
B	27.05.05	ROAD HUMP SIGN ADDED	CD	ML
A	18.03.05	ISSUED FOR CONSTRUCTION	KD	ML

© Parsons Brinckerhoff Australia Pty Limited and Parsons Brinckerhoff International (Australia) Pty limited trading as Parsons Brinckerhoff ("PB") Copyright in the drawings, information and data recorded in this document ("the information") is the property of PB. This document and the information are solely for the use of the authorised recipient and this document may not be used, copied or reproduced in whole or part for any purpose other than that for which it was supplied by PB. PB makes no representation, undertakes no duty and accepts no responsibility to any third party who may use or rely upon this document or the information.
 NCSI certified Quality System to ISO 9001

Scale	A3 ORIGINAL	Drawn	Date
		CFD	
		Designed	
		MD	
		Drawing Check	
		CD	80305
		Design Check	
		MD	80305
		Project Approval	

PARSONS BRINCKERHOFF
 PPK House, Level 3
 9 Blaxland Road
 Rhodes NSW 2138
 Locked Bag 248,
 Rhodes NSW 2138
 Australia

ABN 84 797 323 433
 Telephone +61 2 9743 0333
 Facsimile +61 2 9736 1568
 Email: sydney@pb.com.au

Client	ROADS AND TRAFFIC AUTHORITY OF N.S.W.	Job No	2116280A
Project	PADDINGTON LOCAL AREA TRAFFIC MANAGEMENT GLENMORE ROAD BETWEEN HAMPDEN STREET AND WALKER STREET GENERAL ARRANGEMENT	File No	2116280AC10_C
		Drawing No	C10
		Rev	C

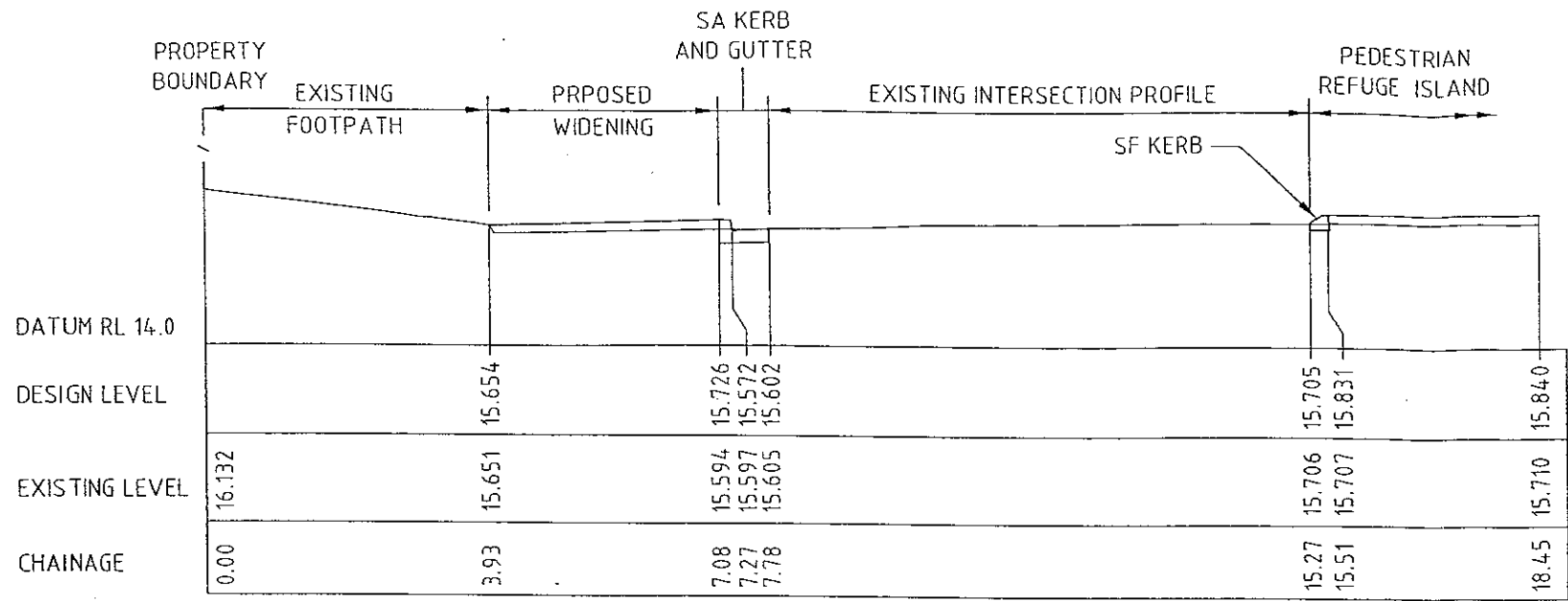

SECTION A
 HORIZONTAL 1:100
 VERTICAL 1:100

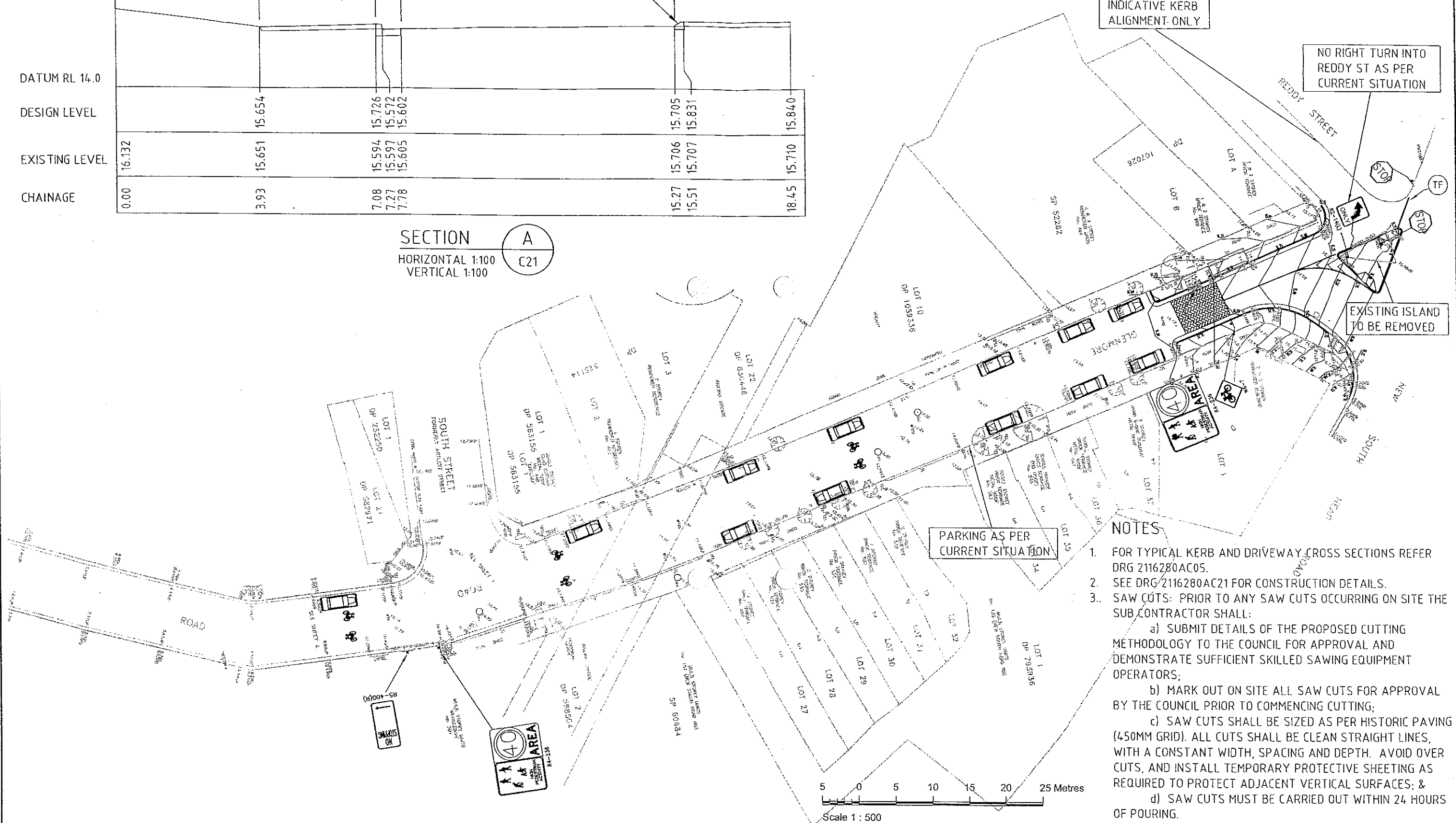

- NOTES**
- FOR TYPICAL KERB AND DRIVEWAY CROSS SECTIONS REFER DRG 2116280AC05.
 - SEE DRG 2116280AC21 FOR CONSTRUCTION DETAILS.
 - SAW CUTS: PRIOR TO ANY SAW CUTS OCCURRING ON SITE THE SUB CONTRACTOR SHALL:
 - SUBMIT DETAILS OF THE PROPOSED CUTTING METHODOLOGY TO THE COUNCIL FOR APPROVAL AND DEMONSTRATE SUFFICIENT SKILLED SAWING EQUIPMENT OPERATORS;
 - MARK OUT ON SITE ALL SAW CUTS FOR APPROVAL BY THE COUNCIL PRIOR TO COMMENCING CUTTING;
 - SAW CUTS SHALL BE SIZED AS PER HISTORIC PAVING (450MM GRID). ALL CUTS SHALL BE CLEAN STRAIGHT LINES, WITH A CONSTANT WIDTH, SPACING AND DEPTH. AVOID OVER CUTS, AND INSTALL TEMPORARY PROTECTIVE SHEETING AS REQUIRED TO PROTECT ADJACENT VERTICAL SURFACES; &
 - SAW CUTS MUST BE CARRIED OUT WITHIN 24 HOURS OF POURING.

FOR CONSTRUCTION

REV	DATE	DESCRIPTION	DRN.	APPR.
B	02.06.05	SAW CUT NOTES ADDED, REISSUED FOR CONSTRUCTION	KD	ML
A	18.03.05	ISSUED FOR CONSTRUCTION	KD	ML

© Parsons Brinckerhoff Australia Pty Limited and Parsons Brinckerhoff International (Australia) Pty limited trading as Parsons Brinckerhoff ("PB") Copyright in the drawings, information and data recorded in this document ("the information") is the property of PB. This document and the information are solely for the use of the authorized recipient and this document may not be used, copied or reproduced in whole or part for any purpose other than that for which it was supplied by PB. PB makes no representation, undertakes no duty and accepts no responsibility to any third party who may use or rely upon this document or the information.

NCSI certified Quality System to ISO 9001

Scale	A3 ORIGINAL	Drawn	CFD	Date	
		Designed	MD	Date	
		Drawing Check	CD	Date	180305
		Design Check	MD	Date	180305
		Project Approval		Date	

PARSONS BRINCKERHOFF

PPK House, Level 3
 9 Blaxland Road
 Rhodes NSW 2138
 Locked Bag 248,
 Rhodes NSW 2138
 Australia

ASB 84 797 323 433
 Telephone +61 2 9743 0333
 Facsimile +61 2 9736 1568
 Email: sydney@pb.com.au

Client	ROADS AND TRAFFIC AUTHORITY OF N.S.W.	Job No	2116280A
Project	PADDINGTON LOCAL AREA TRAFFIC MANAGEMENT NORTHERN END OF GLENMORE ROAD GENERAL ARRANGEMENT	File No	2116280AC20_1
		Drawing No	C20
		Rev	B