

Document tendered by
 Mr Paul Judge
 Received by
 Gareth Perkins
 Date: 13 / 07 / 22
 Resolved to publish Yes / No

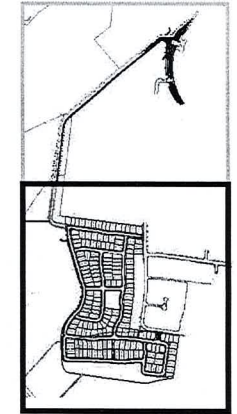

KEY

LEGEND

- Site boundary
- ⊙ Species to be predominantly selected from the Cumberland Plain Woodland Community.
- ⊙ Species to be selected from native tree species
- ⊙ Species to be predominantly selected from the smaller trees within the Riverflat Eucalypt Forest Community
- ⊙ Species to be predominantly selected from the Riverflat Eucalypt Forest Community
- ⊙ Species to be predominantly selected from the Riverflat Eucalypt Forest Community

Refer to DA-1939-103 for tree species and numbers

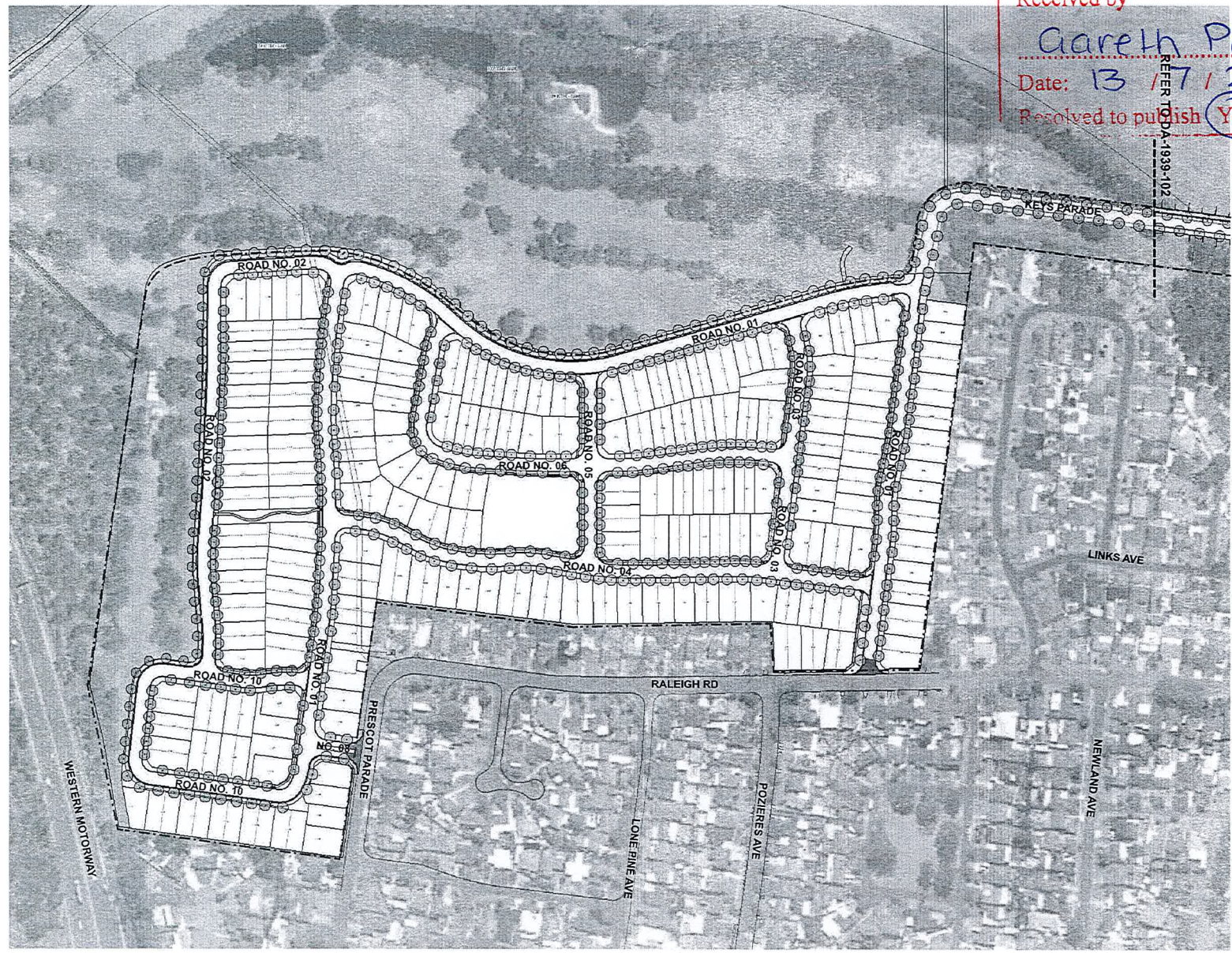

Suite 91, L5, 330 Wattle St
 Ultimo NSW 2007
 T. 02 9211 3744
 W. www.sturt-noble.com.au
Sturt Noble
 Associates
 landscape architecture
 environmental & urban design

PROJECT
MILPERRA RIVERLANDS

CLIENT
MIRVAC

DRAWING
RIVERLANDS DEVELOPMENT STREET TREE MASTERPLAN

DRAWING No.	ISSUE	DRAWN	DATE
DA-1939-101 E		JW	25.03.2022

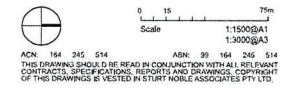

ACN: 164 245 614 ABN: 39 164 245 614
 THIS DRAWING SHOULD BE READ IN CONJUNCTION WITH ALL RELEVANT CONTRACTS, SPECIFICATIONS, REPORTS AND DRAWINGS. COPYRIGHT OF THIS DRAWING IS VESTED IN STURT NOBLE ASSOCIATES PTY LTD.