



LEGISLATIVE COUNCIL

PORTFOLIO COMMITTEES

BUDGET ESTIMATES 2021-2022

Questions on Notice

Portfolio Committee No. 1 – Premier and Finance

THE LEGISLATURE

Hearing: 2 March 2022

Answers due by: 30 March 2022

Budget Estimates secretariat
Phone 9230 2112
BudgetEstimates@parliament.nsw.gov.au

Question (Transcript page 7)

The Hon. MARK BUTTIGIEG: *How many policies that are relevant to the employment of members' staff have been updated in the previous 12 months without any consultation being conducted prior to the policy being updated or changed? I guess this relates to the context of the previous questions. But the question is are there any policies that relate to the employment of members' staff that have been updated in the previous 12 months without any consultation?*

MARK WEBB: *I would have to take that on notice. Sorry, I do not have that information in front of me*

Answer:

There were six policies reviewed in the last 12 months that are applicable to members' staff, as listed below;

- Harassment Free Workplace policy
- Room and Venue Use policy
- Breastfeeding policy
- Cyber Security policy
- Asset Management policy
- Parliamentary and Members' staff Contesting Federal, State and Local Elections Policy.

The process for gathering any feedback from members' staff has been somewhat informal in the past. The Parliament's administration has recently agreed to a more structured consultation process for future policy development.

Question (Transcript page 10)

The Hon. MARK BUTTIGIEG: *Okay. We might just go to some specifics, I think, to tease out some of the issues surrounding this issue. How much of this financial year's allocated budget has been spent?*

MARK WEBB: *We are on track, at the moment. In terms of the exact percentage, I would have to take that on notice, but we are on track to expend what we have been allocated this year.*

Answer:

56% of this years recurrent budget had been spent as at 31 January 2022. We are on track to spend the allocated budget by the end of the financial year.

Question (Transcript page 13)

The Hon. MARK BUTTIGIEG: *President, can I take you back to the part of my question about the accommodation for the press gallery and specifically The Guardian? Where is all that up to?*

The PRESIDENT: *I know that space is at an absolute premium, so I might ask Mr Webb to comment on that specifically.*

The Hon. DON HARWIN: *It's just not, but anyway.*

MARK WEBB: *As you know, we updated the press gallery space a couple of years ago. My trusty team at the end of my computer tells me The Guardian has a permanent spot in that space. There is a little bit of space left down in the press gallery area, but we are utilising pretty much all of it. If it was to be extended any further, we would have to find the location to extend it to. At this point, there is not anything contiguous with the current press gallery that we could expand into.*

The Hon. MARK BUTTIGIEG: *So they are permanently accommodated now, are they? Okay. I just want to go through a couple of numbers, if you like. Feel free to take them on notice, but I think it is important to inform the Committee around some of the detail of the context we just had. In terms of the next tranche of capital works planned for next financial year, can you tell us what that is?*

MARK WEBB: *In terms of the stuff that has already been approved?*

The Hon. MARK BUTTIGIEG: *Yes.*

MARK WEBB: *Do you want a dollar figure?*

The Hon. MARK BUTTIGIEG: *The dollar figure and what sort of capital works we are looking at.*

Answer:

NSW Treasury has approved a total of \$19.4 million across major and minor capital works projects in previous budget processes for the 2022/23 financial year. This includes \$2.9m in minor capital works funding, and \$16.5m for continuing multi-year major projects approved in previous budget processes, including the following major items:

- to continue developing and implementing modern ICT services for Parliament including cloud migration and digital transformation, and replacing ageing infrastructure
- to continue the project to replace the roof membrane at Parliament House
- to continue modernising the audiovisual services in Parliament, including complete replacement of the broadcasting technology in both chambers and three committee rooms
- to continue ceilings and building services replacement at Parliament House.

Question (Transcript page 18/19)

The Hon. DON HARWIN: *From the point of view of staff and any contractors involved, including heritage specialists, architects et cetera, who was involved in taking decisions in relation to that proposal to punch a hole through the wall of the Fountain Court?*

MARK WEBB: *The capital works team prepared the heritage application. I will have to ask them to send through the name of the heritage architect that we used through that period. I do not have that.*

The Hon. DON HARWIN: *So you are taking that on notice?*

MARK WEBB: *I will take that on notice, but if they can provide it to me—*

The Hon. DON HARWIN: *Would you also provide, on notice, the extract from the conservation—I am sorry, I will withdraw that. I have not looked recently; is the conservation management plan on the website?*

MARK WEBB: *Yes, I believe so. LSJ Architecture was the architecture firm. Yes, I believe so; we have not taken it down or anything like that.*

The Hon. DON HARWIN: *Yes, good, thank you. I will re-read that section later. Fine. It was LSJ Architects?*

MARK WEBB: *Yes.*

The Hon. DON HARWIN: *And was the section 60 application dealt with by Sydney city council under delegation from the Heritage Council?*

MARK WEBB: *Yes. That is correct, yes.*

The Hon. DON HARWIN: *And they gave permission?*

MARK WEBB: *They did, yes. And Andrew Andersons did not have any concerns with the proposal.*

The Hon. DON HARWIN: *Was his concurrence sought in writing or was it done verbally?*

MARK WEBB: *I will check that. It was reported back to me, but I will check whether it was sought in writing.*

The Hon. DON HARWIN: *Could you please supply whatever letters were written to Andrew Andersons and whatever reply was sought?*

MARK WEBB: *Yes. Will do.*

Answer:

Mr Andrew Andersons' views were verbally sought. There is no written correspondence.

Question (Transcript page 22)

The Hon. SHAOQUETT MOSELMANE: *You do not foresee any impact. I might ask you a few questions with regards to matters of disability that Ms Abigail Boyd started asking and the President gave some answers. In terms of our employment levels of people with disabilities, are you able to provide us with numbers on those rates of employment from the financial year 2019 until the present? You can take that on notice.*

MARK WEBB: *I might need to take that on notice.*

Answer:**Disability Employment Levels**

	2019	2020	2021	2022
DPS Staff - Disability not requiring adjustment at work	2	1	3	2
DPS Staff - Disability requiring adjustment	1	1	1	1
LC Parliamentary Staff - Disability not requiring adjustment at work	2	2	2	2
LC Parliamentary Staff - Disability requiring adjustment	1	1	0	0

Question (Transcript page 22)

The Hon. SHAOQUETT MOSELMANE: *How many members of staff who work in the Parliament in senior management identify as having a disability?*

MARK WEBB: *I will ask my crack team to send me through the figure while we are talking and jump back in with it when it comes through.*

Answer:

Snr Mgt Staff in NSW Parl with disability (DPS & LC)	
Missing	11
Disability Not Requiring Adjustment	1
Disability Requiring Adjustment	0
No Disability	39
Total	51

Question (Transcript page 35)

The Hon. SHAOQUETT MOSELMANE: Thanks for the answer. The last one you can take on notice. What proportion of items procured for the Parliament are sourced in New South Wales?

MARK WEBB: I will take it on notice. But I will say that our general policy, which has been this way for a long time, is to seek New South Wales sourcing first and, if we cannot source in New South Wales, to source in Australia. Only in those times where we cannot source in Australia—

The Hon. SHAOQUETT MOSELMANE: So you source locally first?

MARK WEBB: Yes, locally first, and then expand out. But I will get you some exact figures. I do have a couple of quick answers to things that you asked that I was not able to answer that I will just do quickly. There are 16 staff in FTE in the library and 10 in the research service, so that is 26 in total across both those areas.

Answer:

Our capital works program aims to use Australian made products, in particular products sourced from New South Wales, wherever possible.

For the first half of financial year 2021/22, 87.5% of purchases were from NSW suppliers.

Recent Australian made procurements include:

- Carpet (NSW)
- Precast concrete pavers, including stone aggregate from Coffs Harbor (NSW)
- Storm water pits and lids (NSW)
- Tower Block membrane engineered screed (NSW)
- Tower Block membrane pipe supports (NSW)
- Air conditioning fan coil units (Assembled NSW)
- Workplace sit to stand desks (NSW)
- Furniture for new workspaces (NSW and VIC).

Question (Transcript page 36)

The Hon. DON HARWIN: *I think I asked for a couple of matters to be dealt with on notice. Is it possible to have them read back so that I can make sure that I didn't miss anything?*

MARK WEBB: *You wanted confirmation about whether the interaction with Mr Anderson happened either verbally or by meeting and letters. If it was in written form, you wanted copies of the correspondence exchanged.*

The Hon. DON HARWIN: *Indeed, and I would also appreciate a copy of the advice that the heritage architect provided to the Parliament.*

MARK WEBB: *Around the door, yes.*

Answer:

For interaction with Mr Andersons, see answer to previous question.

The City of Sydney approved submission for the new café entrance, including the heritage advice, is attached to this document.

Our ref: HCS/2020/416

Robert Nielsen
Parliament House
6 Macquarie St Sydney NSW 2000

By email:

Dear Mr Robert

APPLICATION UNDER SECTION 60 OF THE HERITAGE ACT 1977
Parliament House
STATE HERITAGE REGISTER N^o 01615**Address:** 6 Macquarie St Sydney**Proposal:** Addition of one new door to level 7 public café and removal of one door between the Fountain Court and corridor adjacent to the café at the 1980s building.**Section 60 application no:** s60 HCS/2020/416, received 24/12/2020**Additional information requested:** No

As delegate of the Heritage Council of NSW (the Heritage Council), I have considered the above section 60 application. Pursuant to section 63 of the *Heritage Act 1977*, approval is granted subject to the following conditions:

APPROVED DEVELOPMENT

1. All works shall comply with the information contained within:
 - a) Architectural drawings *NSW Parliament House Cafe* prepared by Lucas Stapleton Johnson & Partners Pty Ltd, as listed in the table below:

Drawing No.	Title	Date	Rev
123060/01/A	New Café Door--Level 7 Plan	13/11/17	
123060/02/A	New café Door--Elevations	13/10/17	

- b) Heritage Impact Statement New Door to Public Bar, prepared by LSJ Heritage Planning & Architecture dated 14th November 2017.
 - c) Addendum Heritage Impact Statement—Proposed Installation of A New Door From the Fountain Court to the Public Café at NSW Parliament, S60 Fast Track Application by Robert Nielsen, Department of Parliamentary Services, Parliament of NSW, dated 22nd December 2020.

EXCEPT AS AMENDED by the conditions of this approval:**CONDITION TITLE****2. NEW MATERIAL TO MATCH EXISTING**

The material, finish and design detail of the new entrance door should match the existing glass wall panels and the main door on the eastern wall of Fountain Court.

Reason: to ensure the new door is visually consistent with the existing glass walls and doors.

SPECIALIST TRADESPERSONS

3. All work to, or affecting, significant fabric shall be carried out by suitably qualified tradespersons with practical experience in conservation and restoration of similar heritage structures, materials and construction methods.

Reason: So that the construction, conservation and repair of significant fabric follows best heritage practice.

HERITAGE CONSULTANT

4. A suitably qualified and experienced heritage consultant must be nominated for this project. The nominated heritage consultant must provide input into the detailed design, provide heritage information to be imparted to all tradespeople during site inductions, and oversee the works to minimise impacts to heritage values. The nominated heritage consultant must be involved in the selection of appropriate tradespersons and must be satisfied that all work has been carried out in accordance with the conditions of this consent.

Reason: So that appropriate heritage advice is provided to support best practice conservation and ensure works are undertaken in accordance with this approval.

SITE PROTECTION

5. Significant built and landscape elements are to be protected during site preparation and the works from potential damage. Protection systems must ensure significant fabric, including landscape elements, is not damaged or removed.

Reason: To ensure significant fabric including vegetation is protected during construction.

COMPLIANCE

6. If requested, the applicant and any nominated heritage consultant may be required to participate in audits of Heritage Council of NSW approvals to confirm compliance with conditions of consent.

Reason: To ensure that the proposed works are completed as approved.

DURATION OF APPROVAL

7. This approval will lapse five years from the date of the consent unless the building works associated with the approval have physically commenced.

Reason: To ensure the timely completion of works.

Advice

Section 148 of the *Heritage Act 1977* (the Act), allows people authorised by the Minister to enter and inspect, for the purposes of the Act, with respect to buildings, works, relics, moveable objects, places or items that is or contains an item of environmental heritage. Reasonable notice must be given for the inspection.

Right of Appeal

If you are dissatisfied with this determination appeal may be made to the Minister under section 70 of the Act.

It should be noted that an approval under the Act is additional to that which may be required from other Local Government and State Government Authorities in order to undertake works.

If you have any questions about this correspondence, please contact Hui Wang, Heritage Specialist

Yours sincerely

Tony Smith, Urban Design & Heritage Manager – City of Sydney

As Delegate of the Heritage Council of NSW

21 January 2021

cc. Heritage NSW

LUCAS STAPLETON JOHNSON

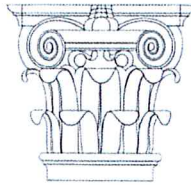

LSJ Heritage Planning & Architecture

Ian Stapleton, B.Sc.(Arch.), B.Arch., Grad.Dip.Env.Law. F.R.A.I.A
Registered Architect No. 4032 Nominated Architect

Sean Johnson, B.A., Dip.Arch., M.Sc.(Arch.Cons.), R.A.I.A.
Registered Architect No. 4728

Associates:

Kate Denny, B.A., M.Herit.Cons.

Michael Gunn, B.Des.Stud., B.Arch.
Registered Architect No.9913

Consultant:

Clive Lucas, O.B.E., B.Arch., D.Sc.(Arch.) (*honoris causa*), Sydney,
L.F.R.A.I.A. Registered Architect No. 2502

Lucas Stapleton Johnson & Partners Pty Ltd

Suite 101, 191 Clarence Street, Sydney NSW 2000 Telephone: 02 9357 4811 Email: mailbox@lsjarchitects.com

ACN: 002 584 189 ABN: 60 763 960 154 Websites: www.lsjarchitects.com www.traditionalaustralianhouses.com

NSW Parliament House, Macquarie Street, Sydney

HERITAGE IMPACT STATEMENT – NEW DOOR TO PUBLIC CAFÉ

Prepared for: Department of Parliamentary Services

Issued: 14th November 2017

Introduction

This Heritage Impact Statement (HIS) has been written to accompany a Section 51(1) Exemption Notification and provides an analysis of a proposal to add a new door to the public café previously known as the Staff Bar, near the Fountain Court on level 7 of the portion of the NSW Parliament House built between 1975 and 1985.

NSW Parliament House is listed as a heritage item on the State Heritage Register (SHR no. 1615). It is included as a heritage item in the City of Sydney Council Local Environmental Plan 2012 (L1864) and identified as an archaeological site in the State Heritage Inventory.

This report was prepared by Grazi Prada of this office with review by Sean Johnson. The site was inspected by Grazi Prada and Sean Johnson on several occasions in the last 3 years. This firm has been involved in the property since c.2007, is well acquainted with the building and prepared the *New South Wales Parliament House, Conservation Management Plan, April 2012* (CMP) for the property.

This report follows generally the methodology recommended by the NSW Heritage Office in *Statement of Heritage Impact* (Revised 2002) and is in accordance with the *Australian ICOMOS Charter for Places of Cultural Significance (The Burra Charter)* and the *NSW Heritage Office Heritage Manual*.

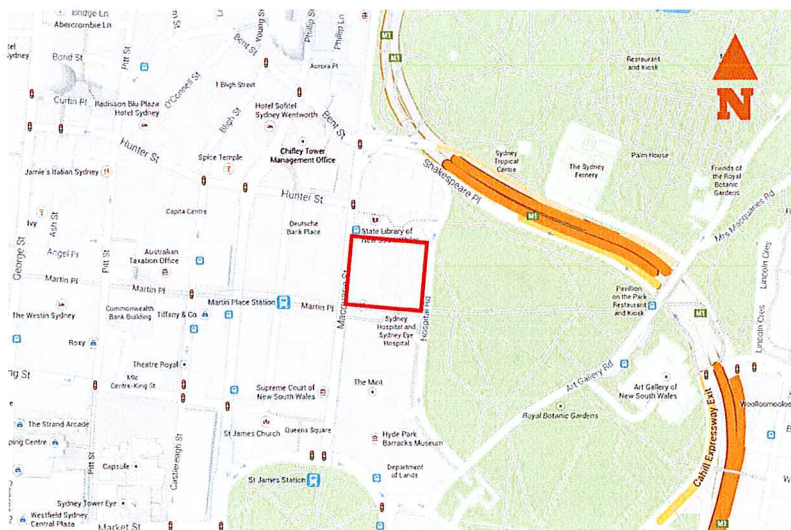

Figure 1: Location Map (Parliament House in red)
(Source: Google Maps, <<http://maps.google.com.au/maps>>)

Historical Background and Significance

Since the history and significance of the Parliament House is already well covered, this report should be read in conjunction with the previous documents. The history provided below is based on the CMP but only those aspects of particular relevance to the Café are repeated here.

Café

The major redevelopment of the NSW Parliament House site undertaken by the Public Works Department between 1975-1985 resulted in a modern building of high architectural quality. The space occupied by the café is immediately adjacent to the Fountain Court, but as it was originally designed as the staff bar, there is no direct access between the two. The only clue for struggling visitors is a small sign above the central glass doors (figure 2).



Figure 2: Existing entrance to café (sign circled).



Figure 3: Existing café west wall.

The Fountain Court is a key part of the design linking the historic Macquarie Street Buildings to the Hospital Road wing. One of its primary successes is its deference to the scale of the 19th century buildings. Therefore, the building should be treated with due care, in order to preserve the integrity of its architectural intent.

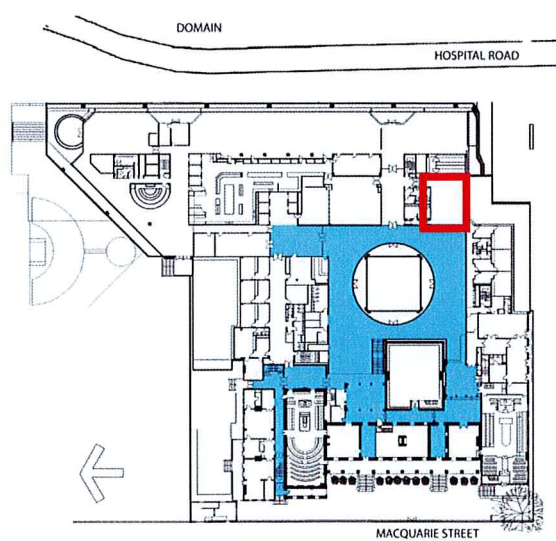

Figure 4: Level 7 plan showing the principal circulation areas shaded. (café in red)
(Source: NSW Parliament House CMP)

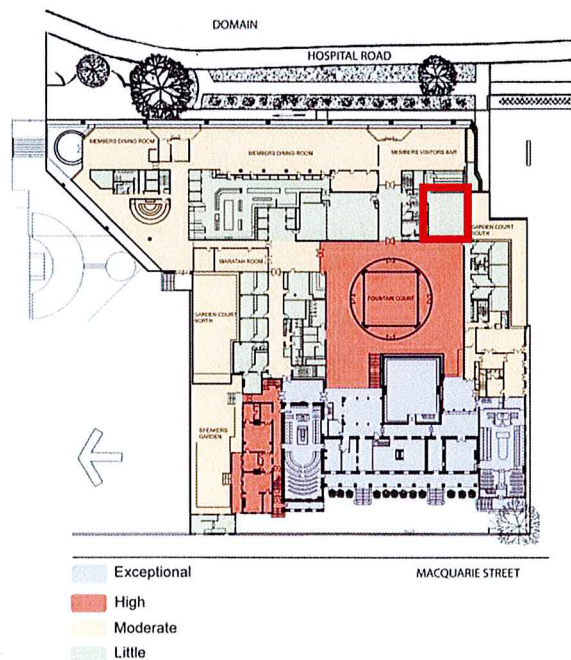

Figure 5: Ranking of Significance diagram, level 7
(café in red)
(Source: NSW Parliament House CMP)

The Proposal

Documents Describing the Proposal

The proposed works are described in the following documents (attached):

- Drawings by Lucas Stapleton Johnson & Partners No: 123060/01 and /02 dated November 2017.

Summary of the Proposal

The works consist of the addition of a new access door between the Fountain Court and the café (originally the Staff Bar) by removal of one timber panel on the café side and one fabric panel on the Fountain Court side as well as masonry in between for the insertion of one new automated sliding door. It also includes the removal of an existing corner door between the Fountain Court and corridor, and infill the opening to match the remainder of the walls.

Assessment

An appropriate assessment methodology is to consider the details of the proposal and to compare them with the recommendations of a properly prepared Conservation Management Plan (CMP) in order to determine whether any aspect of the proposal is not in accordance with the recommended policies. In this case the Conservation Management Plan (CMP) was prepared by Clive Lucas Stapleton & Partners revised March 2012 will be used for this assessment.

CMP Policies:

Policy 1: The principal circulation axes should be kept free from obstructions.

Recommendation: Remove the intrusive elements from the principal circulation axes, e.g., the extension of the security desk in space 766A.

Recommendation: Visual clutter in the Fountain Court should be carefully controlled. Reconsider the location of the Post Office, souvenir shop, and coffee cart in the Fountain Court.

Policy 2: Fabric should be treated in accordance with the different levels of significance assigned in Section 3.4, Grades of Significance

<i>High Significance</i>	<i>Aim to retain all fabric. If adaptation is necessary for the continued use of the place, minimise changes, removal and obscuring of significant fabric and give preference to changes which are reversible.</i>
--------------------------	--

<i>Little Significance</i>	<i>Fabric of little significance may be retained or removed as required for the future use of the place, provided that its removal would cause no damage to more significant fabric.</i>
----------------------------	--

Statement of Heritage Impact

The proposed works will result in very few alterations to significant fabric, namely a small section of wall panels and a glass door to a secondary space. The new door has been kept as narrow as possible to reduce the area of fabric affected, minimise the visual impact on the Fountain Court and leave as much hanging wall space as possible available for exhibitions.

It has been designed to comply with current fire egress and accessibility regulations, is required for the continued use of the space as the NSW Parliament House and will preserve the significance of the spaces in line with the Burra Charter.

Conclusion

The new door is necessary to overcome the difficulty visitors face finding the café, has been carefully designed to minimise alterations to the significant parts of the building, is in accordance with the policies of the CMP and will allow for the continuing use of the space without obstructing the principal circulation axes of the building.

Consequently, in the view of this firm the proposal is suitable for exemption from the Heritage Act under standard Exemption 7: minor activities with little or no adverse impact on heritage significance.

Grazi Prada
Lucas Stapleton Johnson & Partners Pty. Ltd.
Architects and Heritage Consultants

Encls.

- Drawings by Lucas Stapleton Johnson & Partners No 123060/01 and /02 dated November 2017

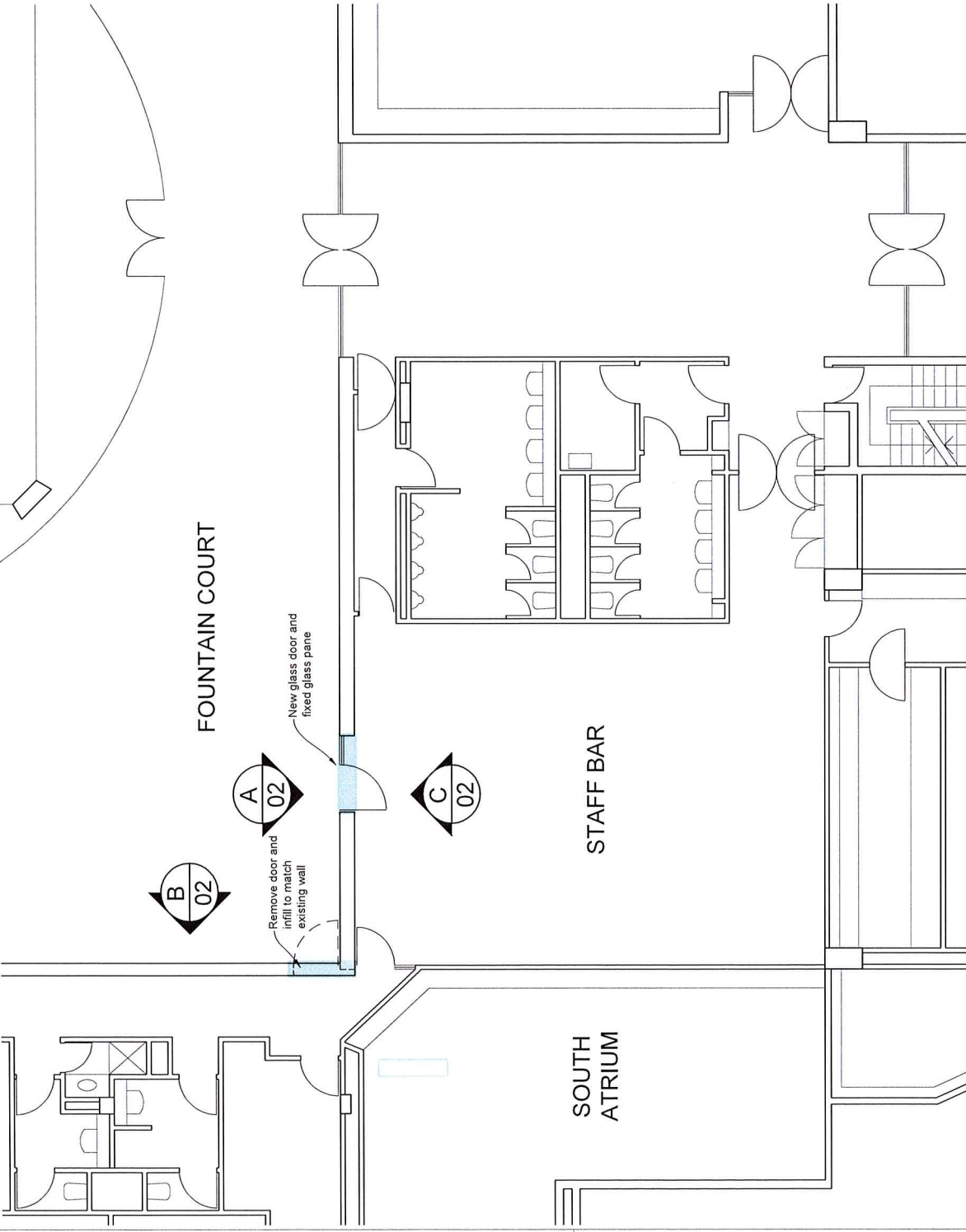
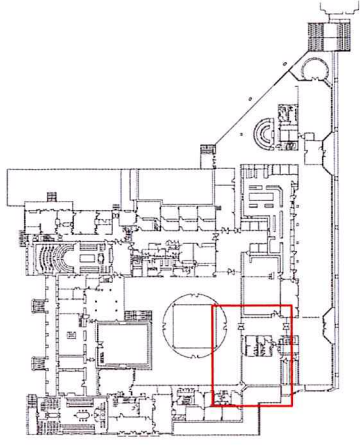

LUCAS STAPLETON JOHNSON LSI Heritage Planning & Architecture ACN 002 584 189 Nominated Architect: Jan Stapleton (reg. 4032) Websites: www.lsjarchitects.com www.traditionalaustralianhouses.com	Date	13.11.17	Scale (at A3)	1:100	Drawn	YC/GzP	Job	NSW PARLIAMENT HOUSE - CAFE	
	Lucas Stapleton Johnson & Partners Pty Ltd Suite 101, Level 11, 191 Clarence Street Sydney, NSW, 2000 Telephone: (02) 93574811 Email: mailbox@lsjarchitects.com							Dwg.	NEW CAFE DOOR - LEVEL 7 PLAN
								Dwg. No.	123060 / 01 / A

HERITAGE ACT 1977
NEW CAFE ENTRANCE PLAN UNDER SECTION 60
 Scale 1:100
 Approved by: **Delegated Authority**
 HCS/2020/416
 21/01/2021

HERITAGE ACT 1977
 123060/01.dwg
 Approved by: Delegated Authority
 HCS/2020/416
 21/01/2021

HERITAGE ACT 1977
 123060/01.dwg
 Approved by: Delegated Authority
 HCS/2020/416
 21/01/2021

LARGER OPENING
 Amendment

A No
 28-11-17 Date

These plans should be read in conjunction with the decision notice

Existing services cavity and concrete beam beyond

New entrance to cafe

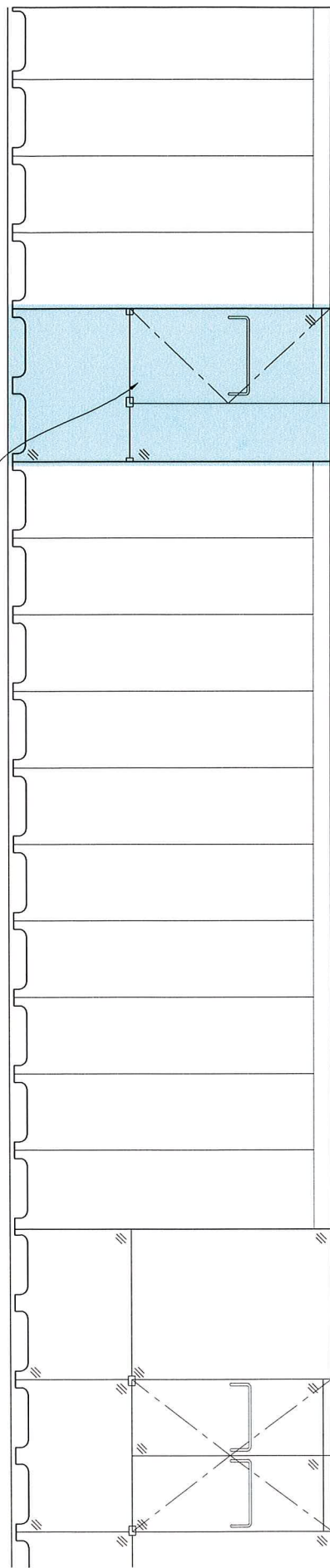

A ELEVATION - FOUNTAIN COURT EAST WALL
Scale 1:50
123060el.dwg

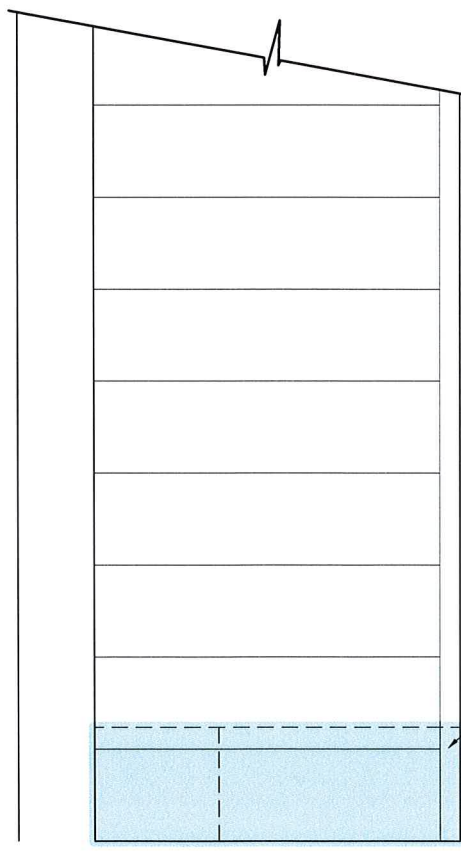

B ELEVATION - FOUNTAIN COURT SOUTH WALL
Scale 1:50
123060el.dwg

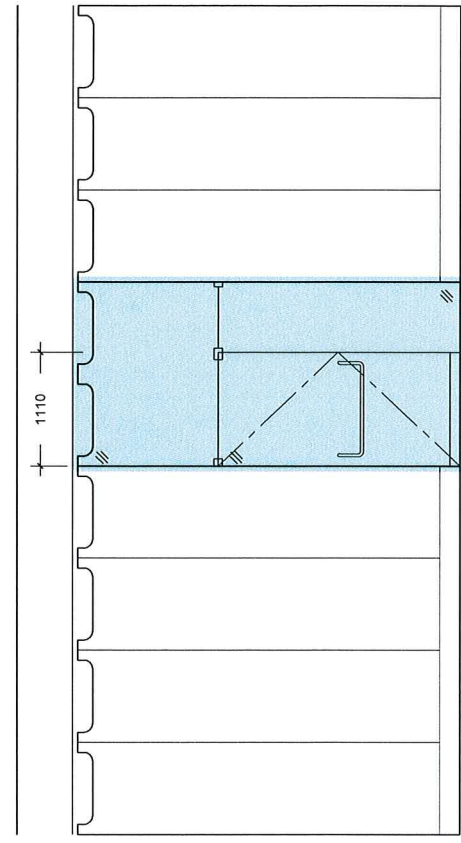

C ELEVATION - STAFF BAR WEST WALL
Scale 1:50
123060el.dwg

HERITAGE ACT 1977
APPLICATION UNDER SECTION 60
Approved by: Delegated Authority
HCS/2020/416
21/01/2021
These plans should be read in conjunction with the decision notice

LUCAS STAPLETON JOHNSON
LSJ Heritage Planning & Architecture
ACN 002 584 189
A/BN 60 763 960 154
Nominate Architect: Ian Stapleton (reg. 4032)
Websites: www.lsjarchitects.com www.traditionalaustralianhouses.com

Date	13.10.17	Scale (at A3)	1:50	Drawn	YC/IGP	Job	NSW PARLIAMENT HOUSE - CAFE
Lucas Stapleton Johnson & Partners Pty Ltd Suite 101, Level 1, 191 Clarence Street Sydney, NSW, 2000 Telephone: (02) 93574811 Email: mailbox@lsjarchitects.com						Dwg.	NEW CAFE DOOR - ELEVATIONS
© Lucas Stapleton Johnson & Partners Pty Ltd Check all dimensions. Figure dimensions to be taken in preference to scale.						Dwg. No.	123060 / 02 / A

28-11-17 Date
A No. Amendment
LUCAS STAPLETON JOHNSON



DEPARTMENT OF PARLIAMENTARY SERVICES
DPS Branch

City of Sydney Council
GOP Box 1591
Sydney 2001
PlanningLodgements@cityofsydney.nsw.gov.au

22 December 2020

Dear Sir/ Madam

RE: ADDENDUM HERITAGE IMPACT STATEMENT – PROPOSED INSTALLATION OF A NEW DOOR FROM THE FOUNTAIN COURT TO THE PUBLIC CAFÉ AT NSW PARLIAMENT, S60 FAST TRACKED APPLICATION

This addendum Heritage Impact Statement (HIS) has been prepared in relation to the proposed installation of a new door providing access from the Fountain Court to the Public Café, located on Level 7 of NSW Parliament, 6 Macquarie Street, Sydney.

The NSW Parliament is listed as a State significant heritage item on the State Heritage Register (SHR), under the *NSW Heritage Act, 1977*. It is also listed on the Sydney Local Environmental Plan (2012) and is identified on the State Heritage Inventory (SHI) and City of Sydney Archaeological Zoning Plan as an archaeological item.

Since preparation of the Heritage Impact Statement (attached) prepared by Lucal Stapleton and Partners Pty Ltd (14 November 2017), the following additional works have been undertaken:

- The proposed width of the door was increased from 895mm to 1110mm to adhere to accessibility standards
- The Conservation Management Plan (CMP) was updated by LSP in 2019

Both are discussed in detail below.

Increase in door width:

In the first instance, the modification made to the proposed width of the door has been revised in order to ensure accessibility issues have been appropriately address. In the first iteration of the design seen in the 2017 HIS (Figure 1), the width of the door was to match approximately the width of the existing panels located within the Fountain Court. However, this width would not allow for wheel chair access through the door. In addition, it was designed as a sliding door, which is no longer proposed.

Investigation was also undertaken to see if two double doors would provide a better outcome, however, it is understood this would not be appropriate as it could not be guaranteed that both doors would remain open at all times to facilitate accessibility. Consequently, the design was revised to have one door leaf, wide enough to meet accessibility standards, with glazing to the north and above (Figure 2). This is considered a positive outcome from an accessibility point of view. In addition, although the design results in additional glazing to the eastern elevation of the Fountain Court and the removal of two panels, it is considered a minor change that will not adversely impact

on the overall aesthetics of the Fountain Court. It will also ensure the Fountain Court remains free of clutter through its contemporary minimalist design, as required in accordance with Policy 13 in the CMP, which notes:

Policy 13: Visual clutter in the Fountain Court should continue to be carefully controlled.

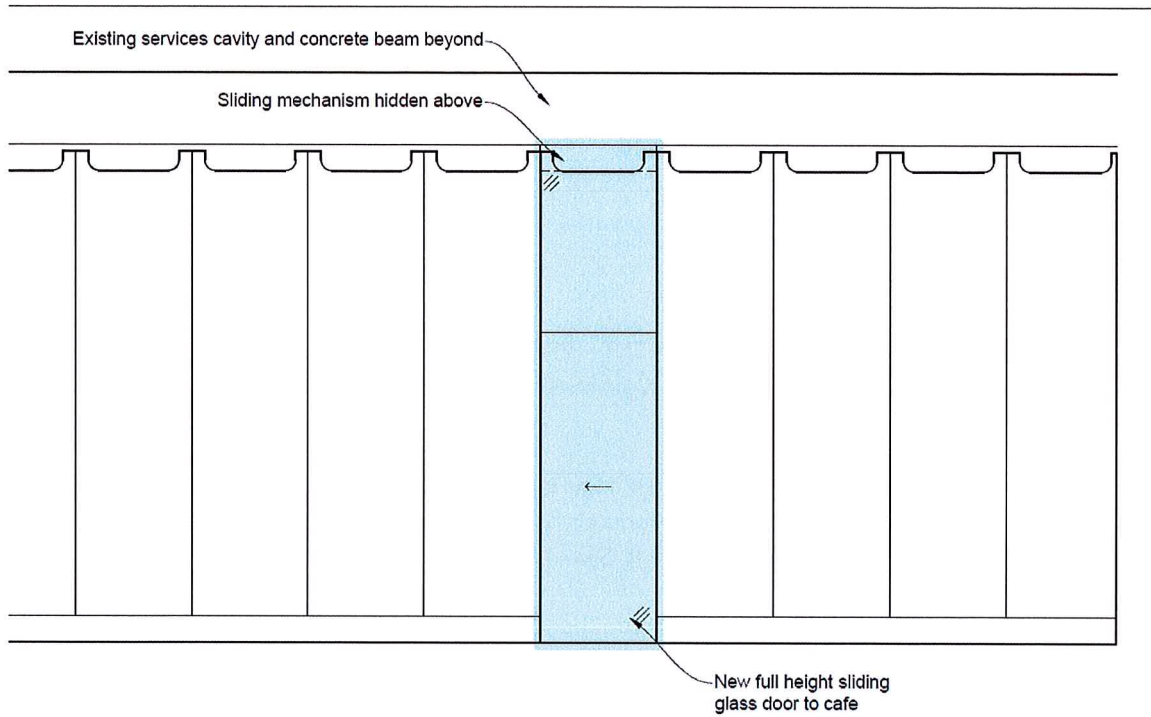

Figure 1: Previous door design, Fountain Court eastern wall elevation. (Source: LSP, drawing no. 123060, 02)

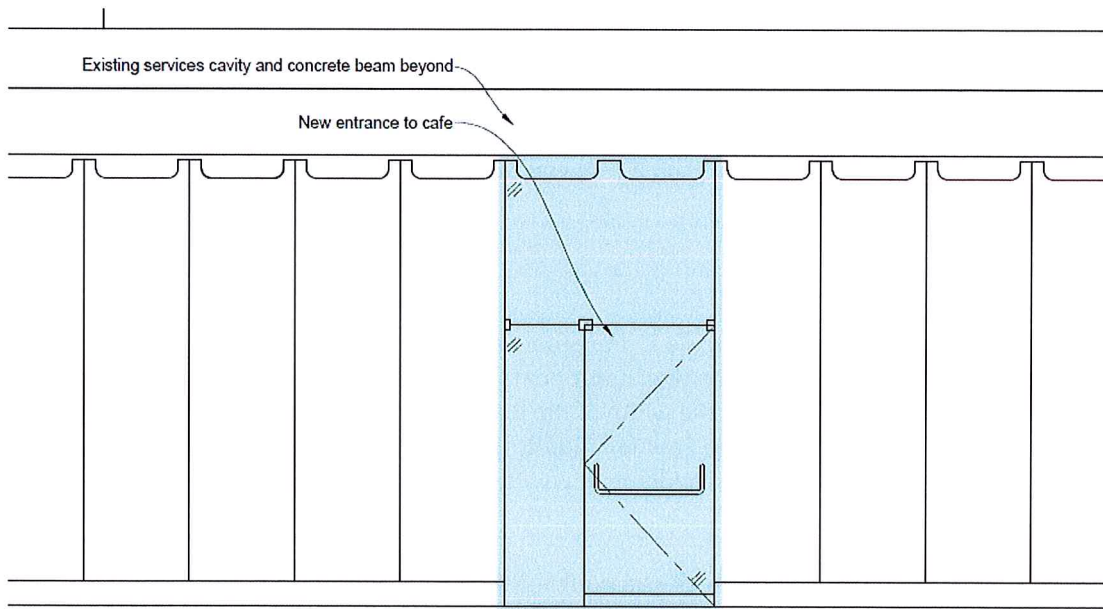

Figure 2: Fountain Court eastern wall elevation showing the proposed Public Café door. (Source: LSP, Drawing no. 123060, 02, A)

CMP Update:

LSP was engaged in 2019 to update the CMP to reflect the changes that had occurred onsite since the previous iteration of the report. Consequently, only minor changes were made to the report predominately within the history and description sections. No major changes were made to the significance rankings or policies within the document.

Therefore, the impact assessment included in the 2017 HIS is considered to relate to the polices and significane rankings in the updated HIS. The proposed installation of a new door to the Public Café from the Fountain Court will have no adverse impact on the Fountain Court or the heritage listed site as a whole. Rather, it will improve accessibility to the Public Café and will fit comfortably within the overall design of the Fountain Court.

We trust the information above and included in the accompanying documentation will satisfy the Council of the City of Sydney and Heritage NSW's requirements in the assessment of the proposed works. Should you require any further information, please do not hesitate to contact us.

Yours sincerely,

Robert Nielsen
Director, Capital Works Strategy and Delivery
Department of Parliamentary Services
Parliament of NSW

